



Index:

Air Operated Pumps..... 16-17
Electrical Driven Pumps 18
Installation Kits 19
Installation Accessories 20-22
Hose Reels 23
Distribution Hoses and Kits 24
Valves and Meters 25
Mobile Units 26-27
Kits for 1000 litre Containers 28
OriPac 29
Hand Operated Pumps 30-32
Oil Bar 32
Funnels, Measures & Oilers 33

Air Operated Oil Pumps

Part.No

Oil Pump, pressure ratio 1:1

Transfer pump for connection to bulk tank or drum.
Remote stub pump version can be wall or floor mounted.
Double acting air operated pump for transferring oil and non-corrosive liquids. Includes a bung adapter G2" (m).

Pressure ratio 1:1

Capacity Max 40 l/min., free flow, at 1,0 MPa, (10 bar)
Air pressure Max 1,0 MPa (10 bar)
Connections Air: G1/4" (f)
Oil: Outlet G3/4" (f)
Inlet (22700) G1" (f)

Weight (approx.) 22700 - 2,8 kg
22705 - 4,4 kg

Description

Stub pump 22700
Stub pump with riser tube (1,2 m - 4ft) and foot valve air eliminator 227004
Barrel pump for 205 litre drums 22705

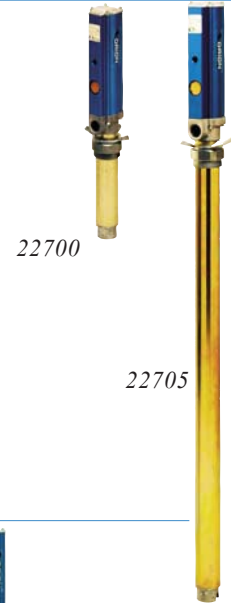

Oil Pump, pressure ratio 3:1

Low pressure pump for the smaller oil distribution system and lower viscosity oils. Suitable for connection to a bulk tank or drum. Remote stub pump version can be wall or floor mounted. Double acting air operated pump for oil and non-corrosive liquids. Includes a bung adapter G2" (m).

Pressure ratio 3:1

Capacity Max 22 l/min., free flow, at 1,0 MPa, (10 bar)
Air pressure Max 1,0 MPa (10 bar)
Connections Air: G1/4" (f)
Oil: Outlet G3/4" (f)
Inlet (22710) G3/4" (f)

Weight (approx.) 22710 - 2,4 kg
22715 - 3,8 kg

Description

Stub pump 22710
Stub pump with riser tube (1,2 m - 4ft) and foot valve air eliminator 227104
Barrel pump for 205 litre drums 22715



Oil Pump, pressure ratio 5:1

Medium pressure pump for the larger oil distribution system and higher viscosity oils. Suitable for connection to a bulk tank or drum. Remote stub pump version can be wall or floor mounted. Double acting air operated pump for oil and non-corrosive liquids. Includes a bung adapter G2" (m).

Pressure ratio 5:1

Capacity Max 38 l/min., free flow, at 1,0 MPa, (10 bar)
Air pressure Max 1,0 MPa (10 bar)
Connections Air: G1/4" (f)
Oil: Outlet G3/4" (f)
Inlet (22750) G1" (f)

Weight (approx.) 22750 - 4,9 kg
22752 - 6,5 kg

Description

Stub pump 22750
Stub pump with riser tube (1,2 m - 4ft) and foot valve air eliminator 227504
Barrel pump for 205 litre drums 22752
Pump for tank, max depth 1 500 mm 227521550



NOTE! Do not use any air operated pump for volatile or highly inflammable liquids like Petrol (Gasoline).

**** The 3:1 and 5:1 pump are equipped with a pressure relief valve. The use of a Pressure Relief Valve protects the system components against excessive system pressure which can result from heat expansion.**

(1°C temperature increase results in approx. 10 bar increase in the static system pressure)

Air Operated Oil Pumps		Part.No
<p>Oil Pump, pressure ratio 15:1</p> <p>High pressure oil pump for applications requiring higher pressure and lower flow rates. Suitable for connection to a bulk tank or drum. Remote stub pump version can be wall or floor mounted. Double acting air operated pump for oil and non-corrosive liquids. Includes a bung adapter G2" (m).</p>		
<p>Pressure ratio 15:1</p> <p>Capacity Max 15 l/min., free flow, at 1,0 MPa, (10 bar)</p> <p>Air pressure Max 1,0 MPa (10 bar)</p> <p>Connections Air: G1/4" (f) Oil: Outlet G3/4" (f) Inlet (22760) G3/4" (f)</p> <p>Weight (approx.) 22760 - 4,7 kg 22762 - 6,4 kg</p>		
<p>Description</p> <p>Stub pump 22760</p> <p>Barrel pump for 205 litre drums 22762</p>		
<p>Oil Pump, pressure ratio 10:1</p> <p>High pressure oil pump for applications requiring higher pressure and higher flow rates. Suitable for connection to a bulk tank or drum. Remote stub pump version can be wall or floor mounted. Double acting air operated pump for oil and non-corrosive liquids. Includes a bung adapter G2" (m).</p>		
<p>Pressure ratio 10:1</p> <p>Capacity Max 40 l/min., free flow, at 0,7 MPa, (7 bar)</p> <p>Air pressure Max 1,0 MPa (10 bar)</p> <p>Connections Air: G1/2" (f) Oil: Outlet G3/4" (f) Inlet (22410) G1 1/2" (f)</p> <p>Weight (approx.) 22410 - 14 kg 22412 - 16 kg</p>		
<p>Description</p> <p>Stub pump 22410</p> <p>Barrel pump for 205 litre drums 22412</p>		
<p>Oil Pump, High Performance, ratio 2:1</p> <p>Low pressure high performance oil pump for applications requiring higher flow rates. Suitable for connection to a bulk tank or drum. Can be wall or floor mounted. Double acting air operated pump for oil and non-corrosive liquids.</p>		
<p>Pressure ratio 2:1</p> <p>Capacity Max 60 l/min., free flow, at 1,0 MPa, (10 bar)</p> <p>Air pressure Max 1,0 MPa (10 bar)</p> <p>Connections Air: G1/4" (f) Oil: Outlet G3/4" (m) Inlet G3/4" (m)</p> <p>Weight (approx.) 22780 - 10 kg</p>		
<p>Description</p> <p>High Performance 2:1 Oil Pump 22780</p>		

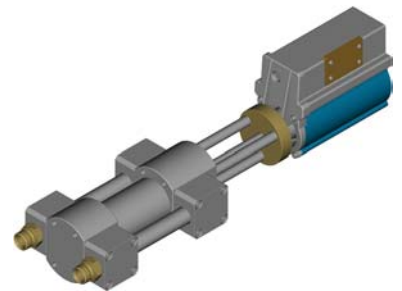

Electric pump**Part.No****Electric Pump for Oil**

Self-priming electric gear pump, with built in by-pass and pressure switch for controlled oil dispensing. The pressure switch switches the pump on/off automatically when the oil valve is open/closed. Suitable for use with hydraulic oil, gear oil and other lubricating oils.

Inlet/outlet: G1”(f). Voltage: 230 V, 50 Hz.

Capacity*	Max pressure	Min pressure	Engine power	Part.No
9,5 l/min	12 bar	6 bar	0,6 kW	52510
13 l/min	16 bar	6 bar	0,78 kW	52515
9,5 l/min	25 bar	6 bar	0,78 kW	52520

* Engine oil (SAE 10W30) at 20C



Installation Kits for 227-series Pumps	Part.No	
<p>Drum Pump Installation Kit Components for a drum mounted air operated oil pump. (205 litre drum or tank)</p> <p>Information Air line hose 1,5 metre x 1/4" bore hose Oil line hose 1,5 metre x 3/4" bore hose</p> <p><i>Note! Pump not included.</i></p>	99625	
<p>Wall mounted Pump Installation Kit Components for a remote wall mounted air operated oil pump with drum suction attachment (205 litre drum)</p> <p>Information Air line hose 1,5 metre x 1/4" bore hose Oil line hose 1,5 metre x 3/4" bore hose Drum suction attachment (28310) with 2,0 metre hose and 1,0 metre tube.</p> <p><i>Note! Pump not included.</i></p>	99626	
<p>Wall mounted Pump Installation Kit Components for a remote wall mounted air operated oil pump with a suction hose connected to the bottom tank outlet</p> <p>Information Air line hose 1,5 metre x 1/4" bore hose Oil line hose 1,5 metre x 3/4" bore hose Oil suction hose (28078) 1,0 metre hose</p> <p><i>Note! Pump not included.</i></p>	99627	
<p>Floor mounted Pump Installation Kit Components for a remote floor mounted air operated oil pump with a suction hose connected to the bottom tank outlet</p> <p>Information Air line hose 1,5 metre x 1/4" bore hose Oil line hose 1,5 metre x 3/4" bore hose Oil suction hose (28080) 1,0 metre hose</p> <p><i>Note! Pump not included.</i></p>	99628	
<p>Wall mounted Pump Installation Kit Components for a remote wall mounted air operated oil pump with a tank suction attachment</p> <p>Information Air line hose 1,5 metre x 1/4" bore hose Oil line hose 1,5 metre x 3/4" bore hose Oil suction attachment (28311) 2,0 metre hose and 1,7 metre tube.</p> <p><i>Note! Pump not included.</i></p>	99629	

If you have a need for tanks, don't hesitate to contact us!

Installation Accessories

Part.No

Pump Tubes for Drum and Tank Mounted Pumps, including a Foot Valve Air Eliminator.

All the pump tubes listed below are designed for use with our stub pumps when installed in metered circuits for resale purposes.

Description	For pump	Part.No
Pump tube for 205 litre drum	22700, 27750	28315
Pump tube for 205 litre drum	22710	28316
Pump tube for 1,2 metre (4 ft) deep tank	22700, 22750	28317
Pump tube for 1,2 metre (4 ft) deep tank	22710	28318

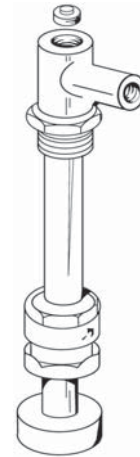

28319

Pump tubes including a Foot Valve Air Eliminator for Wall Mounted Stub Pump Applications, with priming facility and non-return valve when using a remote pump. G3/4"(f)

Description	Part.No
Pump tube for 1,2 metre (4 ft) deep tank	28319
Pump tube for 1,8 metre (6 ft) deep tank	28320

Bung Adapters

With split collars for pump tube diameters shown below. G2" (m) thread for drum or drum covers.

For pump tube diameter	Fits Orion pump models	Part.No
32	22710, 22715, 22760, 22762	28585
50	21650, 22700, 22705, 22720, 22725, 22750, 22752	28595
54	22770, 22775, 22410, 22412	2125753

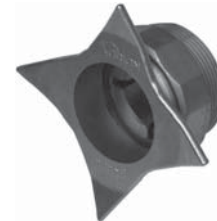

Air Treatment Units

Description	Conn. thread	Consist of:	Part.No
Air Treatment Unit	G1/4" (f)	42007, 42009, 42012, 301296	42003

Accessories:	Part.No
Bracket for Air Treatment Unit mounted on top of 22750-60 series pumps.	2026154
Air hose for Air treatment unit	2226155



2026154



42003



2226155

Air Line Hoses

For connection of air motor to air ring main, made of armoured PVC, max. working pressure 1,5 MPa (15 bar), swaged couplings; one with swivelling nut and connection adapter (male/male).

Description	Hose Diameter	Length	Conn. thread	Part.No
Air line hose	1/4" i.d.	1,5 m	G1/4"(m)	48001
Air line hose	1/4" i.d.	3 m	G1/4"(m)	480013M
Air line hose	3/8" i.d.	1,5 m	G3/8"(m)	48002
Air line hose	1/2" i.d.	2 m	G1/2"(m)	48017



Installation Accessories				Part.No	
Drum Cover Protection (205 litre Drums) Keeps drum cover and surroundings clean.					
No/box	Diam.	Absorbing capacity	Weight/box		
25	Ø56cm	2 l/sheet	3,6 kg	DTA25	
1	Ø56cm	2 l/sheet	145 g	DTA1	
Pressure Relief Valve For protection of equipment against system pressure increase due to heat expansion. (1°C increase in temperature can cause 1,0 MPa, 10 bar increase in system pressure). Our 3:1 and 5:1 oil pumps are fitted with a pressure relief valve as standard.					
Description	Information				
Pressure relief valve	Releases pressure at 6 MPa (60 bar), with the possibility to connect a 1/4" hose or R1/8" fitting.			28623	
Banjo fitting	G 3/4" (m/f) and G1/4" (f) to fit the PRV to pumps without special PRV connection			28629	
Pressure Relief Hoses.					
Description					
Made of PVC to connect the PRV to a drum, L = 1,5 m, without fittings.				28637	
Made of PVC to connect the PRV to a tank, L = 3 m, with swaged fittings.				28638	
Connection Oil Hoses Connection hose of Nitrile rubber, wire braided, swaged couplings with swivelling nuts and adapter.					
Description					
Tank connection hose, Length 1,0 m, with two straight couplings, G1".				28078	
Tank connection hose, Length 1,0 m, with one straight and one 90°-angle coupling, G1". Mainly used with pumps mounted in floor stands.				28080	
Oil connection hose, Length 1,5 m, with two straight couplings, G1" and G3/4".				28079	
Drum Suction Attachments Riser tube with foot valve and G2" bung adapter, hose 1" i.d., with swaged couplings G1" swivelling nut incl. two adapters, G1" (m) - G1" (m) and G1" (m) - G3/4" (m).					
Riser tube length	Hose length				
1,08 m	2,0 m			28310	
1,7 m	2,0 m			28311	
Wall Brackets and Floor Stands For mounting of pump. Pump mounting thread G2" (f).					
Description					
Wall bracket				28524	
Floor stand				28506	
Wall bracket for 22410 and 22412				28554	

Installation Accessories

Part.No

Oil Filters

For mounting in pipe lines to prevent damage due to contamination. Body of aluminium.

Description	Conn. thread	Strainer rating	Max pressure	Part.No
Oil filter	G3/4" (f)	20 µm	6 MPa (60 bar)	24661
Oil filter	G3/4" (f)	10 µm	6 MPa (60 bar)	24662
Cartridge for 24662		10 µm		2345893
Cartridge for 24661		20 µm		2345892



Oil Strainers

For mounting in pipe lines to prevent meters being damaged due to contamination. Washable cartridge of stainless steel. Max 5 MPa (50 bar).

Conn. threads	Strainer rating	Body material	Dimension	Part.No
G1/2" (f)	200 µm	Brass		28022
G3/4" (f)	200 µm	Brass		28059
In G3/4" (f) - Out G1/2 (f) 25 µm		Aluminium	ø60x111 mm	24583



Shut-off Valves

Ball-valves made of brass with PTFE-seals, long or short levers, intended for oil and air lines.

Conn. thread (f)	PN	Lever	Part.No
G3/8"	6,4 MPa (64 bar)	Long	30101117
G1/2"	6,4 MPa (64 bar)	Long	30101093
G3/4"	4,0 MPa (40 bar)	Long	30101111
G1"	4,0 MPa (40 bar)	Long	30101081
G 1 1/4"	2,5 MPa (25 bar)	Long	30101087
G 1 1/2"	2,5 MPa (25 bar)	Long	30101084
G2"	2,5 MPa (25 bar)	Long	30101102
G1/4"	6,4 MPa (64 bar)	Short	30101129
G3/8"	6,4 MPa (64 bar)	Short	30101144
G1/2"	6,4 MPa (64 bar)	Short	30101123



Connection Adapters

Required when connecting hoses to pumps.

Description	Part.No
0101-16-12 Adapter, G1" (m) - G3/4" (m)	25102065
0101-16 Adapter, G1" (m) - G1" (m)	25102011



Hose Reel, inlet Strainer Connection Kits

For installation in pipe lines to prevent damage due to contamination. Makes it easy to carry out maintenance on meters, valves etc. Includes strainer, valve, adapter and 2 dowty seals.

Description	Conn. thread	Reels	Part.No
Conn. kit	G1/2" (f)	For 3/8" or 1/2" reels	99633
Conn. kit	G3/4" (f)	For 3/4" or 1" reels	99634

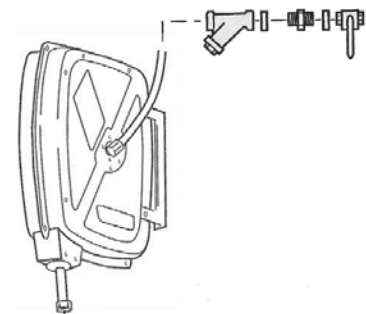

More information in the Hose reel section!

Spring Operated Hose Reels						Part.No
Series ORK						
Open hose reel with a steel braided hydraulic hose, fitted with swaged couplings.						
	Length m	Diameter mm-inch	Conn. threads	Working Pressure MPa bar		
Series ORK	10	12,5 - 1/2"	G1/2"	7,5	75	24911
Series ORM						
Open hose reel with a steel braided hydraulic hose, fitted with swaged couplings.						
	Length m	Diameter mm-inch	Conn. threads	Working Pressure MPa bar		
Series ORM	15	12,5 - 1/2"	G1/2"	7,5	75	24922
Series ORL						
Heavy duty open hose reel with longer hose lengths, fitted with swaged couplings.						
	Length m	Diameter mm-inch	Conn. threads	Working Pressure MPa bar		
Series ORL	20	12,5 - 1/2"	G1/2"	7,5	75	24931
Series ORL	15	19-3/4"	G3/4"	7,5	75	24932
Series OR						
Open hose reel with longer hose lengths, fitted with swaged couplings.						
	Length m	Diameter mm-inch	Conn. threads	Working Pressure MPa bar		
Series OR	20	12,5 - 1/2"	G1/2"	6	60	24920
Series LOR						
Open hose reel with steel braided, oil resistant rubber hose.						
	Length m	Diameter mm-inch	Conn. threads	Working Pressure MPa bar		
Series LOR	25	12,5 - 1/2"	G1/2"	6	60	24941
Series LOR	20	19-3/4"	G3/4"	6	60	24943
Series LOR	15	25 - 1"	G1"	6	60	24945
Series MR						
A medium sized enclosed hose reel. The hose reel can be mounted on the ceiling, the wall or the floor. The wall bracket can easily be moved to fit other installations.						
	Length m	Diameter mm-inch	Conn. threads	Working Pressure MPa bar		
Series MR	15	10 - 3/8"	G3/8"	7,5	75	824905
Series MR	10	12,5-1/2"	G1/2"	7,5	75	824910
Series CR						
Enclosed hose reels with swaged couplings.						
	Length m	Diameter mm-inch	Conn. threads	Working Pressure MPa bar		
Series CR	15	10 - 3/8"	G3/8"	6	60	24905
Series CR	10	12,5-1/2"	G1/2"	6	60	24910



Distribution Hoses and Kits

Part.No

Distribution Hoses for Oil

Nitrile rubber hoses, 1/2" i.d. steel braided, PN 13,8 MPa (138 bar), swaged couplings G1/2" swivelling nuts, incl. two connection adapters, G1/2" (m) - G1/2" (m) and G1/2" (m) - G3/4" (m).

Hose length	2 m	28009
	3 m	28010
	4 m	28011
	5 m	28012
	6 m	28013

**Hose Storage Rack**

Designed for max. 30 m x 1/2"-hose, made of ø 8 mm round iron, finished with brown epoxy lacquer. Two fixing holes ø6 mm for wall mounting. Dimensions: approx. 310 x 130 x 130 mm (W x H x D).

28251

**Hose Storage Brackets****Description**

A wall mounting bracket for storage of hoses, tools etc. Two fixing holes ø5 mm.

6027

For fixing to the wall to support hoses that otherwise would interfere with the work area. Two fixing holes ø5 mm.

28185

**Hose Reel Distribution Kits**

These kits consist of an oil strainer, shut-off valve, hose end control options and drip pocket. Just select the required reel.

Hose end control/Part no	Conn. Thread	Drip pocket/part no	
Oil control valve 24560	G 1/2"	29020	99635
Oil control valve 2468010	G 1/2"	29020	99636
Oil control valve 2468050	G 1/2"	29020	99637
Oil control valve 24563	G 3/4"	29020	99638
Digital commercial meter 2470010	G 1/2"	29020	99640
Digital commercial meter 2470050	G 1/2"	29020	99641
Digital commercial meter 24780	G 1/2"	29020	99642
Digital pre-set meter 2470210	G 1/2"	29020	99645
Digital pre-set meter 2470250	G 1/2"	29020	99646
Digital Board of Trade approved meter 24101/D	G 1/2"	29020	99604

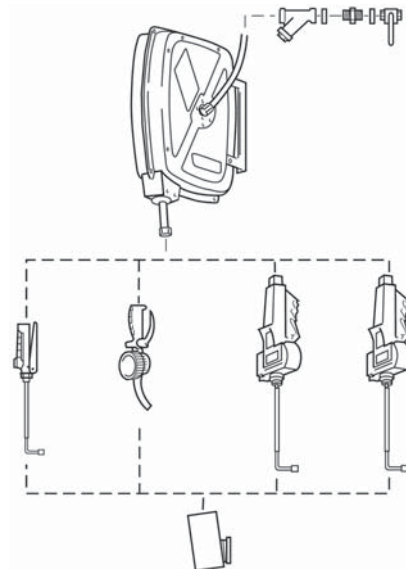

Do not forget the reel!

Oil Control Valves and Meters		Part.No
Digital Hose End meters		
Description		
Hose End Meter	complete with swivel, inlet strainer, outlet hose battery and non-drip nozzle	24780
Hose End Meter	complete with swivel, inlet strainer, battery, rigid outlet tube, and non-drip nozzle	2470010
Hose End Meter	complete with swivel, inlet strainer, battery, non-drip nozzle and adjustable outlet hose	2470050
Preset Hose End Meter	complete with swivel, inlet strainer, battery, rigid outlet tube and non-drip nozzle	2470210
Preset Hose End Meter	complete with swivel, inlet strainer, battery non-drip nozzle and adjustable outlet hose	2470250
For other meter configurations refer to the Hose End Control section!		
Oil Control Valve		
Control valve made in aluminium, large flow capacity. Max pressure: 10,5 Mpa (105 bar). Swivel included. Inlet G1/2" (f).		
Description		
Oil Control Valve	without outlet tube	24675
Oil Control Valve	with 60° rigid tube and semi-automatic nozzle	24560
Oil Control Valve	with hose and semi-automatic nozzle	24561
Control Valve		
The control valve has an inlet strainer which minimizes the contamination risk. Max working pressure 5 MPa (50 bar), inlet G1/2" (m).		
Description		
Control Valve	Rigid outlet (24170), non drip nozzle (24527) and swivel (24586).	2468010
Control Valve	Hose outlet (2285346), non drip nozzle (24527) and swivel (24586).	2468050
For other control valve configurations, refer to the Hose End Control section!		
Oil Control Valve		
High volume oil control valve for high flow of lubricants. Two-valve operation. Lockable trigger. Ball bearing swivel. Rigid outlet with semi-automatic non-drip nozzle.		
Maximum flow	Maximum pressure:	Inlet thread:
48 l/min	10 MPa (100 bar)	G3/4"(f)
		24563
Drip Holsters		
To protect hose end meters and control valves when not in use and to collect any oil drips.		
Description		
Drip holster		29020
Drip holster		29600

Mobile Oil Dispensers, Air Operated

Part.No

De-luxe Mobile Oil Dispensers for 20 and 60 litre drums.

Consisting of a pump, fitted to the lid of a protective container, oil hose and oil control valve. The container is mounted on a trolley fitted with two large rubber wheels and two swivel castors.

Oil pump/ pressure ratio.	For drum	Max. drum- diameter	Length oil hose	L x W x H (mm)	Weight (approx.)
22705/1:1	60 litre	ø 405 mm	3 m	650x510x1280	23 kg
22700/1:1	20 litre	ø 320 mm	2 m	400x400x800	15 kg

26016
25016

26016



Hand pump

21650	60 litre	ø 405 mm	1,5 m	650x510x1280	22 kg
21650	20 litre	ø 320 mm	1,5 m	400x400x800	12 kg

26006
25006

Accessories:

Description	For De-Luxe	Dimension	
Empty 60 litre drum*	26006, 26016	ø 365 x 680 mm	2345386
Empty 20 litre drum*	25006, 25016	ø 295 x 375 mm	1825106

* Inner container

Mobile Oil Dispensers for 60 litre drums

Consisting of an oil pump 22705, 1/2" oil hose (3m) with hose end meter and drum trolley 28526 or 28528.

Description	Dimension (WxDxH)	Del. with trolley	Hose end meter	
Oil dispenser	450 x 620 x 1200 mm	28528	24700	22052
Oil dispenser	500 x 450 x 1250 mm	28526	24700	22053
Oil dispenser	450 x 620 x 1200 mm	28528	24780	22152
Oil dispenser	500 x 450 x 1250 mm	28526	24780	22153

22052



22053



Mobile Oil Dispensers for 200 litre drums

Consisting of an oil pump 22705, 1/2" oil hose (3m) with hose end meter and drum trolley.

Description	Dimension (WxDxH)	Del. with trolley	Hose end meter	
Oil dispenser	450 x 620 x 1200 mm	28276	24700	22054
Oil dispenser	450 x 620 x 1200 mm	28645	24780	22154

Trolley 28645



22054



If you have a need for Oil Dispensers in other configurations don't hesitate to contact us!

Mobile Oil Dispensers				Part.No	
Mobile Oil Dispensers for 20 and 60 litre drums Trolley (28528) with chain for holding 60 litre drums with two ø 155 mm wheels. Pump delivered with 1,5 m outlet hose and hooked outlet nozzle.					
Description	Dimension (WxDxH)	Pump	Hose		
Oil dispenser	450 x 230 x 1200 mm	21650	28569		
Oil dispenser	450 x 230 x 1200 mm	21506	24599		
Strap 1,5 meters long for small kegs				40801327	
Mobile Oil Dispenser for 60 litre drums with Heavy Duty Trolley Trolley (28526) with tubular drum support and a clamp screw for fixing the drum, two ø 75 mm swivel castors and two ø200 mm wheels. Pump (21650) delivered with 1,5 m outlet hose (28569), shut-off valve and hooked outlet nozzle.					
Description	Dimension (WxDxH)	Del. with trolley			
Oil dispenser	450 x 230 x 1200 mm	28528		21658	
Mobile Oil Dispenser for 200 litre drums Consists of a hand operated oil pump (21503), 1/2" oil hose (1,5m) with 135° angled spout, valve and drum trolley.					
Description	Dimension (WxDxH)	Del. with trolley			
Oil dispenser	450 x 620 x 1200 mm	28645		21504	
Mobile Oil Dispenser Mobile steel container with G2" (f) pump mounting thread, ø30 mm filler hole, sight gauge and two ø100 mm (4") wheels. Complete with hand operated oil pump, 1,2 m hose and straight ø20 mm outlet tube.					
Description	Volume (approx.)	Capacity (approx.)	Dim. (mm) LxWxH		Weight (approx.)
Mobile oil dispenser	24 l	0,13 l/stroke*	350x 380x780		12,2 kg
Bare container without pump					29011
* Engine oil, +20°C.					
Mobile Oil Dispenser Air operated oil dispenser, comprising of a steel container with G2" (f) pump mounting thread, fitted with a compressed air connection and pressure gauge, ø30 mm filler hole, sight gauge and two ø100 mm wheels. Pre-load the container with compressed air 0,3-0,7 MPa (3-7 bar), and the dispenser can be used without permanent connection to air pressure. Max. admissible tank capacity is 3/4 of total capacity. Complete with 1,2 m hose and oil control valve 24560.					
Description	Volume	Dim. (LxWxH)	Weight (approx.)		
Oil dispenser	approx. 24 l	350 x 380 x 780 mm	11,5 kg	21036	

Distribution Kits for 1000 Litre Containers

Part.No

Distribution Kit

1:1 ratio air operated oil pump (22700) mounted on a bracket on the side on the container. The pump outlet is fitted with a shut off valve with hooked outlet nozzle for dispensing directly into measures or containers.

Note! Delivered without the container.

Bracket only

SPEC206
IBCT

92126

**Distribution Kit**

3:1 ratio air operated oil pump (22710) mounted on a bracket on the side on the container. The pump outlet is fitted with a 3 metre ½” distribution hose and digital hose end meter (24780).

Note! Delivered without the container.

Bracket only

SPEC206
IBCM

92126

**Distribution Kit**

3:1 ratio air operated oil pump (22710) mounted on a bracket on top of the container. Supplied with a 10 metre ½” hose reel (24911) and digital hose end meter (24780).

Note! Delivered without the container.



Bracket only

SPEC206
IBCRM

92128

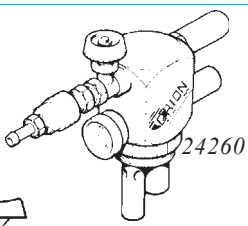
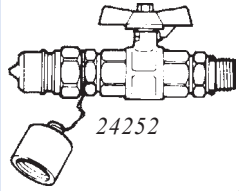
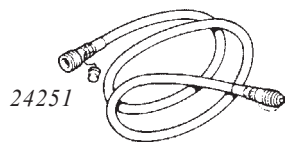
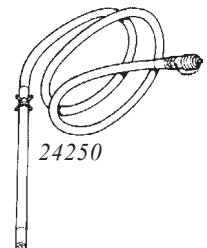

Contact us for other configuration options!

OriPac		Part.No								
<p>OriPac 75</p> <p>OriPac 75 incorporates a 75 ltr capacity container, an air operated oil pump (pressure ratio 3:1), built-in filter (20µm), level indicator and hose reel with 10 m of 1/2" hose complete with oil control valve. For filling the container from a barrel or tank, a vacuum pump and hose kit can be supplied, see accessories below.</p> <table border="1"> <thead> <tr> <th>Description</th> <th>Volume</th> <th>Weight (approx.)</th> <th>Dimension (LxWxH)</th> </tr> </thead> <tbody> <tr> <td>OriPac 75</td> <td>75 litre</td> <td>58 kg (empty)</td> <td>595 x 260 x 1300 mm</td> </tr> </tbody> </table>		Description	Volume	Weight (approx.)	Dimension (LxWxH)	OriPac 75	75 litre	58 kg (empty)	595 x 260 x 1300 mm	<p>24210</p> 
Description	Volume	Weight (approx.)	Dimension (LxWxH)							
OriPac 75	75 litre	58 kg (empty)	595 x 260 x 1300 mm							
<p>OriPac 150</p> <p>OriPac 150 incorporates a 150 ltr capacity container, an air operated oil pump (pressure ratio 3:1), built-in filter (20µm), level indicator and hose reel with 10 m of 1/2" hose complete with oil control valve. For filling the container from a barrel or tank, a vacuum pump and hose kit can be supplied, see accessories below.</p> <table border="1"> <thead> <tr> <th>Description</th> <th>Volume</th> <th>Weight (approx.)</th> <th>Dimension (LxWxH)</th> </tr> </thead> <tbody> <tr> <td>OriPac 150</td> <td>150 litre</td> <td>90 kg (empty)</td> <td>595 x 520 x 1300 mm</td> </tr> </tbody> </table>		Description	Volume	Weight (approx.)	Dimension (LxWxH)	OriPac 150	150 litre	90 kg (empty)	595 x 520 x 1300 mm	<p>24220</p> 
Description	Volume	Weight (approx.)	Dimension (LxWxH)							
OriPac 150	150 litre	90 kg (empty)	595 x 520 x 1300 mm							
<p>OriPac 150L</p> <p>OriPac 150L incorporates a 150 ltr capacity container, an air operated oil pump (pressure ratio 3:1), built-in filter (20µm), level indicator and hose reel with 10 m of 1/2" hose complete with oil control valve. Also included is an additional air supply hose with 15 m x 3/8" hose. For filling the container from a barrel or tank, a vacuum pump and hose kit can be supplied, see accessories below.</p> <table border="1"> <thead> <tr> <th>Description</th> <th>Volume</th> <th>Weight (approx.)</th> <th>Dimension (LxWxH)</th> </tr> </thead> <tbody> <tr> <td>OriPac 150L</td> <td>150 litre</td> <td>105 kg (empty)</td> <td>595 x 520 x 1300 mm</td> </tr> </tbody> </table>		Description	Volume	Weight (approx.)	Dimension (LxWxH)	OriPac 150L	150 litre	105 kg (empty)	595 x 520 x 1300 mm	<p>24221</p> 
Description	Volume	Weight (approx.)	Dimension (LxWxH)							
OriPac 150L	150 litre	105 kg (empty)	595 x 520 x 1300 mm							
<p>Filling Pump</p> <p>Air operated vacuum pump adapted for easy filling of OriPac. Automatic stop at max. level. Quick coupling nipple for suction hose (part No 24250 and 24251) included.</p> <table border="1"> <thead> <tr> <th>Description</th> <th>Capacity</th> <th>Air consumption.</th> </tr> </thead> <tbody> <tr> <td>Fill pump for OriPac</td> <td>max. 40 l/min, depending on viscosity</td> <td>approx. 60 l/min - 0,1 bar</td> </tr> </tbody> </table>		Description	Capacity	Air consumption.	Fill pump for OriPac	max. 40 l/min, depending on viscosity	approx. 60 l/min - 0,1 bar	<p>24260</p> 		
Description	Capacity	Air consumption.								
Fill pump for OriPac	max. 40 l/min, depending on viscosity	approx. 60 l/min - 0,1 bar								
<p>Gravity Drain Valve</p> <p>To be used for horizontally mounted drums.</p> <p>Description Gravity drain valve</p>		<p>24252</p> 								
<p>Suction Hose for Horizontal Mounted Drums</p> <p>To be used together with 24252.</p> <p>Description Suction hose</p>		<p>24251</p> 								
<p>Suction Hose for Vertical Mounted Drums</p> <p>For drums (60-200 litre). Bung adapter G2" (m) included.</p> <p>Description Suction hose length approx. 2 m</p>		<p>24250</p> 								
<p>Other</p> <p>Description Replacement cartridge for oil filter, 20 µm</p> <p>Replacement cartridge for oil filter, 10 µm</p>		<p>2345892</p> <p>2345893</p>								

Hand Operated Pumps

Part.No

Rotary Pump for Oil

Rotary pump made of cast iron with ø26 mm outlet pipe and G2" (m) bung adapter.

Description	Suction tube length	Suction tube diam.	Capacity (approx.)**	Weight (approx.)
Rotary pump	900 mm	ø 32 mm	0,25 l/turn	5,1 kg

21205

** Engine oil, +20°C.



Rotary Pump for Oil, Water Based Fluids and Other Chemicals

Rotary pump made of polypropylene with ø27 mm outlet pipe and G2" (m) bung adapter.

Description	Suction tube length	Suction tube diam.	Capacity (approx.)**	Weight (approx.)
Rotary pump	tube in 3 sections	ø 44 mm	0,3 l/turn **	1,8 kg

21200

** Engine oil, +20°C.



Drum Pump

For transfer of oil and non corrosive fluids from 60 litre (110 lbs) and 205 litre (400 lbs) drums. Made of aluminium and steel with Nitrile seal, rigid outlet pipe, bung adaptor and telescopic suction tube. Capacity 0,45 l/stroke (0.12USG/stroke) approx. 16l/min (4 1/4 USG/min)

Description	For drum	Capacity (approx.)**
Drum pump, telescopic	60 to 200 litres	0,45 l/stroke

21012

** Engine oil, +20°C.



Drum Pump





Medium pressure lever pump for high viscosity lubricants, For transfer of oil and non corrosive fluids from 60 litre (110 lbs) and 205 litre (400 lbs) drums. Made of steel with Nitrile seal and rubber hose (1,5 m) with angled spout and valve. Capacity 0,1 l/stroke .

Description	For drum	Capacity (approx.)**
Drum pump with outlet hose	60 litres	0,1 l/stroke
Drum pump with outlet hose	200 litres	0,1 l/stroke
Outlet hose, 1,5 meters, with 135° angled spout and valve		

21506
21503
24599

** Engine oil, +20°C.



Hand Operated Pumps		Part.No																									
<p>Drum Pumps</p> <p>Pump with a telescopic (500-900 mm) suction tube. The lever can be mounted in different positions to change the stroke length and output. Delivered with a bung adapter G2”(m). Capacity 0,15 to 0,25 litres/stroke.</p> <p>Pump-only , outlet thread G 1/2” (m) with telescopic suction tube.</p> <ul style="list-style-type: none"> - with hooked outlet tube (28567). - with outlet hose 1,5 m (28568) and hooked outlet nozzle. - with In-Line Meter - (24720) for mounting between the pump and outlet hose 1,5 m (28568) with hooked outlet nozzle. 		 <p>21650 21651 21652 21662</p>																									
<p>Drum Pumps</p> <p>The lever can be mounted in 3 different positions to change the stroke length and output capacity, see below. Delivered with telescopic suction tube, G2” and G1 1/2” bung adapter. Suction tube length 340-900 mm, diameter 40 mm.</p> <table border="1"> <thead> <tr> <th>Description</th> <th>Colour</th> <th>Material pump</th> <th>Mtrl Rod</th> <th>Weight (approx)</th> </tr> </thead> <tbody> <tr> <td>Drum pump</td> <td>black/blue</td> <td>Polypropylene</td> <td>Steel</td> <td>0,85 kg</td> </tr> <tr> <td>Drum pump</td> <td>black/green</td> <td>Polypropylene</td> <td>Steel</td> <td>0,85 kg</td> </tr> </tbody> </table> <p>Capacity (Engine oil 20°C) Lever mounted in position: 1. 0,3 l/stroke, 2. 0,37 l/stroke, 3. 0,45l/stroke</p>		Description	Colour	Material pump	Mtrl Rod	Weight (approx)	Drum pump	black/blue	Polypropylene	Steel	0,85 kg	Drum pump	black/green	Polypropylene	Steel	0,85 kg	 <p>21210 21211</p>										
Description	Colour	Material pump	Mtrl Rod	Weight (approx)																							
Drum pump	black/blue	Polypropylene	Steel	0,85 kg																							
Drum pump	black/green	Polypropylene	Steel	0,85 kg																							
<p>Drum Pumps</p> <p>Drum pump with telescopic suction tube. Made of polypropylene and polyethylene with Nitrile rubber seals. G2” (m) bung adapter and outlet with 3/4” hose socket for max. 2 m long hose with open exit.</p> <table border="1"> <thead> <tr> <th>Description</th> <th>Colour</th> <th>Suction tube length</th> <th>Suction tube diam.</th> <th>Capacity (approx.)**</th> </tr> </thead> <tbody> <tr> <td>Drum pump</td> <td>black/blue</td> <td>480 - 950 mm</td> <td>ø27 mm</td> <td>0,3 l/stroke</td> </tr> <tr> <td>Drum pump</td> <td>black/red *</td> <td>480 - 950 mm</td> <td>ø27 mm</td> <td>0,3 l/stroke</td> </tr> <tr> <td>Drum pump</td> <td>black/green *</td> <td>480 - 950 mm</td> <td>ø27 mm</td> <td>0,3 l/stroke</td> </tr> <tr> <td>Drum pump</td> <td>black/yellow *</td> <td>480 - 950 mm</td> <td>ø27 mm</td> <td>0,3 l/stroke</td> </tr> </tbody> </table> <p>* On special order and minimum quantity only. ** Engine oil, +20°C.</p> <p>Suction Tube - Telescopic, max length 950 mm (standard) Hose socket For 3/4”-hose Suction tube Telescopic, max length 1100 mm (extra long) O-ring kit O-ring kit Viton</p>		Description	Colour	Suction tube length	Suction tube diam.	Capacity (approx.)**	Drum pump	black/blue	480 - 950 mm	ø27 mm	0,3 l/stroke	Drum pump	black/red *	480 - 950 mm	ø27 mm	0,3 l/stroke	Drum pump	black/green *	480 - 950 mm	ø27 mm	0,3 l/stroke	Drum pump	black/yellow *	480 - 950 mm	ø27 mm	0,3 l/stroke	 <p>21022 2102210 2102220 2102230</p> <p>2410027 2410028 2410031 2480437</p>
Description	Colour	Suction tube length	Suction tube diam.	Capacity (approx.)**																							
Drum pump	black/blue	480 - 950 mm	ø27 mm	0,3 l/stroke																							
Drum pump	black/red *	480 - 950 mm	ø27 mm	0,3 l/stroke																							
Drum pump	black/green *	480 - 950 mm	ø27 mm	0,3 l/stroke																							
Drum pump	black/yellow *	480 - 950 mm	ø27 mm	0,3 l/stroke																							
<p>Drum Adaptors and Accessories</p> <table border="1"> <thead> <tr> <th>Description</th> <th>Information</th> </tr> </thead> <tbody> <tr> <td>Adapter *</td> <td>G2” (f) - Trisure ø 55 mm, pitch approx. 4 mm (m)</td> </tr> <tr> <td>Adapter</td> <td>G2” (f) - Multi adapter with locking screw ø 55-65 mm (f)</td> </tr> <tr> <td>Press neck</td> <td>To be used together with adapter 28236, ø 45-55 mm (f)</td> </tr> <tr> <td>Adapter</td> <td>G2” (f) - Mauser ø 68 mm, pitch approx. 6 mm (m)</td> </tr> <tr> <td>Adapter*</td> <td>G2” (f) - Berg ø 53 mm, pitch approx. 3,5 mm (f)</td> </tr> </tbody> </table> <p>* For 21022 only Other adaptors available on special request.</p>		Description	Information	Adapter *	G2” (f) - Trisure ø 55 mm, pitch approx. 4 mm (m)	Adapter	G2” (f) - Multi adapter with locking screw ø 55-65 mm (f)	Press neck	To be used together with adapter 28236, ø 45-55 mm (f)	Adapter	G2” (f) - Mauser ø 68 mm, pitch approx. 6 mm (m)	Adapter*	G2” (f) - Berg ø 53 mm, pitch approx. 3,5 mm (f)	 <p>28235 28236 28237 28238 28239</p>													
Description	Information																										
Adapter *	G2” (f) - Trisure ø 55 mm, pitch approx. 4 mm (m)																										
Adapter	G2” (f) - Multi adapter with locking screw ø 55-65 mm (f)																										
Press neck	To be used together with adapter 28236, ø 45-55 mm (f)																										
Adapter	G2” (f) - Mauser ø 68 mm, pitch approx. 6 mm (m)																										
Adapter*	G2” (f) - Berg ø 53 mm, pitch approx. 3,5 mm (f)																										

Hand Operated Pumps

Part.No

Suction Pumps

For filling and emptying of small containers, gear boxes etc.

Description	Volume	Part.No
Suction pump	500 cm ³	21040
Suction pump	800 cm ³	21044



Hand Pump

Simple hand pump. The nozzle is pressed against the fitting. Made of zinc coated steel.

Description	Volume	Dimension	Part.No
Hand Pump	150 cm ³	ø 44 x 245 mm	21019



Lever Hand Pump

Outlet tube with hydraulic coupling included.

Description	Weight	Dimension LxWxH	Part.No
Lever Hand Pump	1,1 kg	310x160x90 mm	21046



Portable Oil Dispensers

Portable oil pump fitted to a 16 litre container with carrying handle. Supplied with a 1,5m hose and angled outlet tube.

Description	Container	Dimension (LxWxH)	Capacity (approx.)*	Weight (approx.)	Part.No
Oil dispenser	OriCan	400x150x900 mm	0,04 l/stroke	5,0 kg	21574
Oil dispenser	OriCan	400x150x900 mm	0,1 l/stroke	5,0 kg	21578
Oil dispenser	OriCan	400x150x900 mm	0,15-0,25 l/stroke	5,0 kg	21670
Oil dispenser	Oval steel	380x170x620	0,1 l/stroke	7,85 kg	21016
Oil dispenser	Round steel	490x240x730	0,13 l/stroke	6,5 kg	21015

* Engine oil, +20°C.



21574

21670



21016

21015

Oil Bar

Oil dispensing bar for 1 to 4 products. Delivered with 1 valve for 1 product. Can be fitted with up to 4 valves for 4 different products.

Description	Dimension (W x D x H)	Part.No
Oil dispensing bar	460 x 300 x 580 mm	24101
Extra valve kit		24509



Drum Tap, Oil Cans, Measures etc.			Part.No
Drum Taps			
Drum Tap for horizontal oil drums.			
Description	Material	Conn. thread	
Drum Tap, push valve	Aluminium, Nitrile rubber	G2" (m)	24506
Drum Tap, slide valve	Cast iron	G2" (m)	24598
Drum Tap, slide valve	Cast iron	G3/4" (m)	24597
			 
Oil Cans			
Description		Volume	
Oil can		0,33 litre	21622
Oil can, Nickel plated with vertical outlet tube		0,30 litre	21623
Oil can, Nickel plated with horizontal outlet tube and handle		0,30 litre	21624
			  
Plastic Measures			
Measuring jugs with handle, made of heavy Polyethylene, resistant to oil, gasoline and chemicals.			
Description	Volume		
Liquid measure	1 litre		21625
Liquid measure	2 litres		21626
Liquid measure	5 litres		21627
			  
Tin Measures			
Measuring jugs with handle, made of tinned metal, resistant to oil, gasoline and chemicals.			
Description	Volume		
Liquid measure	0,5 litre		21636
Liquid measure	1 litres		21637
Liquid measure	2 litres		21638
			  
Oil Containers			
Container with handle, made of heavy polyethylene. Filling hole with lid and capped nozzle			
Description	Volume		
Liquid measure	6 litres		21644
Liquid measure	10 litres		21645
			
Funnels			
Funnels with handle, made of oil and chemical resistant Polyethylene with splash rim and removable brass strainer.			
Description	Volume		
Funnel with straight spout	1,3 litres		21630
Funnel with spout off-set approx 180 mm	1,3 litres		21631
Funnel with flexible spout, 3 spout diameters	1,3 litres		21632
Funnel kit (65, 75, 100 och 120 mm)	0,05-0,27 litre		21633
			   
Tin Funnels			
Funnels with handle, made of tinned metal, resistant to oil, gasoline and chemicals.			
Description	Dimension		
Tin funnel	160 mm		21628
Tin funnel	200 mm		21629
Threaded spout	300 mm		21634
			 

Notes:

A series of horizontal dotted lines for taking notes, spanning the width of the page below the 'Notes:' label.